

UPTO 100 mm RECESS

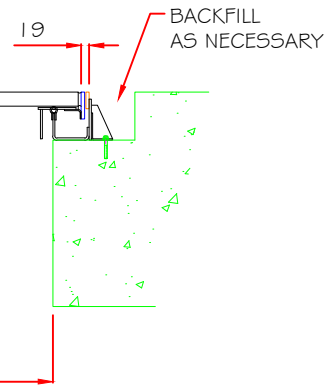

GAS SPRING BRACKET MUST BE SUPPORTED & FIXED TO STRUCTURAL OPENING BY OTHERS

HIAC MATERIAL: ALUMINIUM CAN ACCOMMODATE ANY TYPE OF FLOOR INFILL

|   |  |   |
|---|--|---|
| Copyright is claimed in this drawing and no copy may be made without prior written permission | The article shown is also the subject of |   |
|   | patent rights                            | ✓ |
|   | registered design right                  | ✓ |
|   | unregistered rights                      | ✓ |
|   | The drawing is a design document         | ✓ |
|   | patent pending                           | ✓ |

WIND RESTRAINTS SHOULD BE SPECIFIED ON ALL ACCESS HATCHES SUBJECT TO HIGH WIND CONDITIONS

THIS IS A MANUALLY OPERATED ACCESS HATCH/COVER AND IT IS ESSENTIAL THAT SAFE MEANS OF ACCESS IS PROVIDED FOR THE OPERATOR.

| ITEM NO   | NO OFF | DRG NO. | ITEM MASS | DENOMINATION                          | MATERIAL    | REMARKS |
|---|--------|---------|-----------|---------------------------------------|-------------|---------|
| Existing law protects SURESPAN'S right of possession to this drawing. The design or the drawing must not, without permission of the company, be published, copied, reproduced, manufactured or exploited in any other unauthorized way. |        |         |           | HIAC RECESSED FLOOR HATCH 1000 x 2000 |             |         |
|   |        |         |           | CONTRACT NO.                          | DRAWING NO. | REV No  |
| DRAWING MADE BY CAD<br>MANUAL CHANGES PROHIBITED  |        |         |           | DRAWN BY<br>DATE                      |             |         |